

COMMERCIAL DRIVEWAY KEY NOTES on C-101 'A'

GENERAL NOTES FOR WORK WITHIN STATE R.O.W. on MAIN STREET (RT. 5)

- Any damages caused within the ROW to features that are to remain by/during construction shall be replaced/repaired to NYSOT current Standards and Specifications.

- The existing reference marker ("greenie") and traffic signs on Main Road shall remain.

- ALL WORK WITHIN RIGHT-OF-WAY (R.O.W.) SHALL COMPLY WITH ALL APPLICABLE WORK ZONE TRAFFIC CONTROL (W.Z.T.C.). REFER TO NYSOT Standard Sheets 619-010, 619-011, 619-012, and 619-307.
- EXISTING EASTERLY DRIVEWAY ON MAIN ROAD TO REMAIN IN PLACE. PROVIDE EXTENDED PAVEMENT RADIUS TO MEET 'MINOR COMMERCIAL DRIVEWAY' DESIGN. ESTABLISH TURF ADJACENT TO PAVEMENT.
- INSTALL H.D. ASPHALT PAVEMENT SECTION FOR NEW MINOR COMMERCIAL DRIVEWAY MODIFICATION TO MAIN ROAD (AKA MAIN STREET). (REFER TO PAVEMENT DETAIL AND ALL APPLICABLE N.Y.S.D.O.T. DRAWING SHEETS).
- EXTEND EXISTING 12" H.D.P.E. DRAINAGE CULVERT PIPE (MATCH EXISTING) AT EXISTING DRIVEWAY TO BE WIDENED WITHIN THE MAIN ROAD (N.Y.S. RTE. 5-S.H. No. 131) HIGHWAY R.O.W. AT OUTFALL OF PROPOSED DETENTION BASIN WITH A NYSOT APPROVED PRECAST DRAINAGE EXISTING DRAINAGE DITCH. COMPLY WITH NYSOT FOR INSTALLATION STANDARDS AND SPECIFICATIONS. SEE UTILITY PLAN.
- REMOVE EXISTING DRIVEWAY PAVEMENT SECTION FROM BACKSIDE OF EXISTING AT-GRADE FLUSH SHOULDER ON MAIN ROAD. SAWCUT PAVEMENT AT ANGLE TO MATCH GRAVEL WITH FLUSH GRADE. ESTABLISH TURF AS REQUIRED WITHIN R.O.W. PER N.Y.S.D.O.T. REQUIREMENTS. CLOSE THE DRIVEWAY DURING WORK REMOVING EXISTING DRIVEWAY PAVEMENT. GRAVEL AND SUB-BASE IN THE R.O.W. PLACE SUITABLE FILL, 4" (MIN.) OF TOPSOIL AND ESTABLISH TURF TO MATCH EXISTING TURF ALONG HIGHWAY. COMPLY WITH ALL N.Y.S.D.O.T. STANDARDS.
- REMOVE EXISTING COMMERCIAL WOOD SIGN (PRIVATE SIGN) AND FENCE POSTS WITHIN R.O.W. PLACE SUITABLE FILL, 4" OF TOPSOIL AND ESTABLISH TURF TO MATCH EXISTING TURF ALONG HIGHWAY. COMPLY WITH ALL APPLICABLE N.Y.S.D.O.T. STANDARDS.
- ESTABLISH TURF (LANDSCAPING) AT ALL DISTURBED AREAS - PROVIDE TOPSOIL AND ESTABLISH TURF WITHIN R.O.W. PER N.Y.S.D.O.T. STANDARD SPECIFICATION- SECTION 200 (TYP.) MATCH EXISTING GRADES WITH SMOOTH TURF ESTABLISHMENT.
- INSTALL 8" H.D.P.E. DRAINAGE OUTFALL PIPE FROM NEW PROJECT STORM DRAINAGE CONTROL STRUCTURE AT DETENTION SWALE. COMPLY WITH NYSOT FOR PIPE INSTALLATION STANDARDS AND SPECIFICATIONS. SEE UTILITY PLAN FOR LOCATION AND INVERTS. REFER TO 'SITE REDEVELOPMENT DESIGN & STORMWATER DRAINAGE REPORT' FOR STORM WATER CALCULATIONS WITH HYDROGRAPHS.

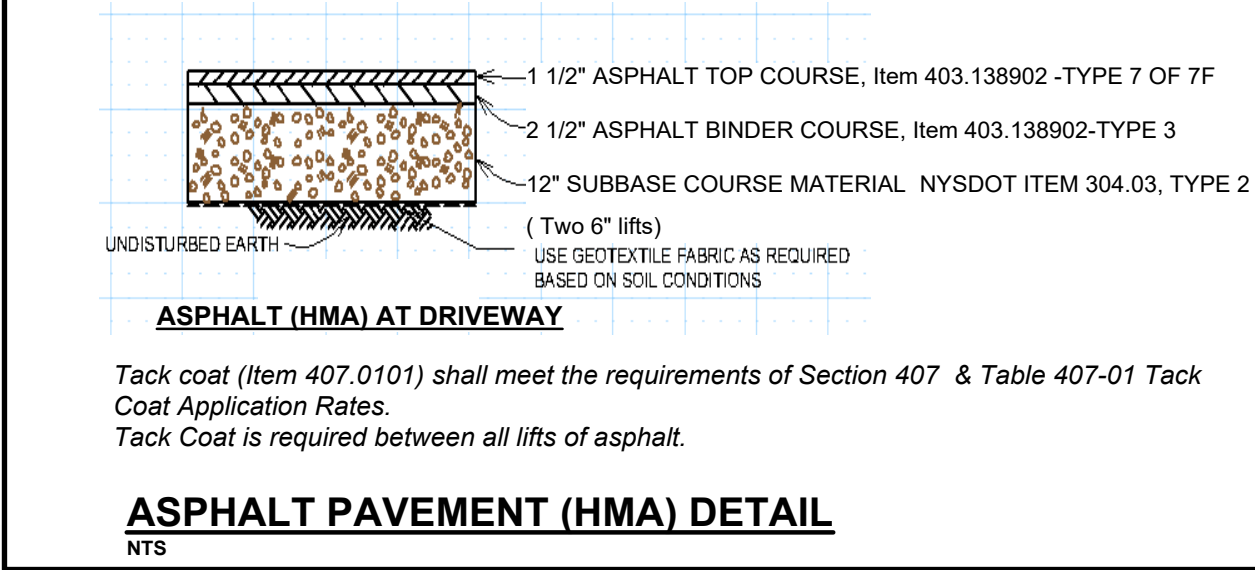
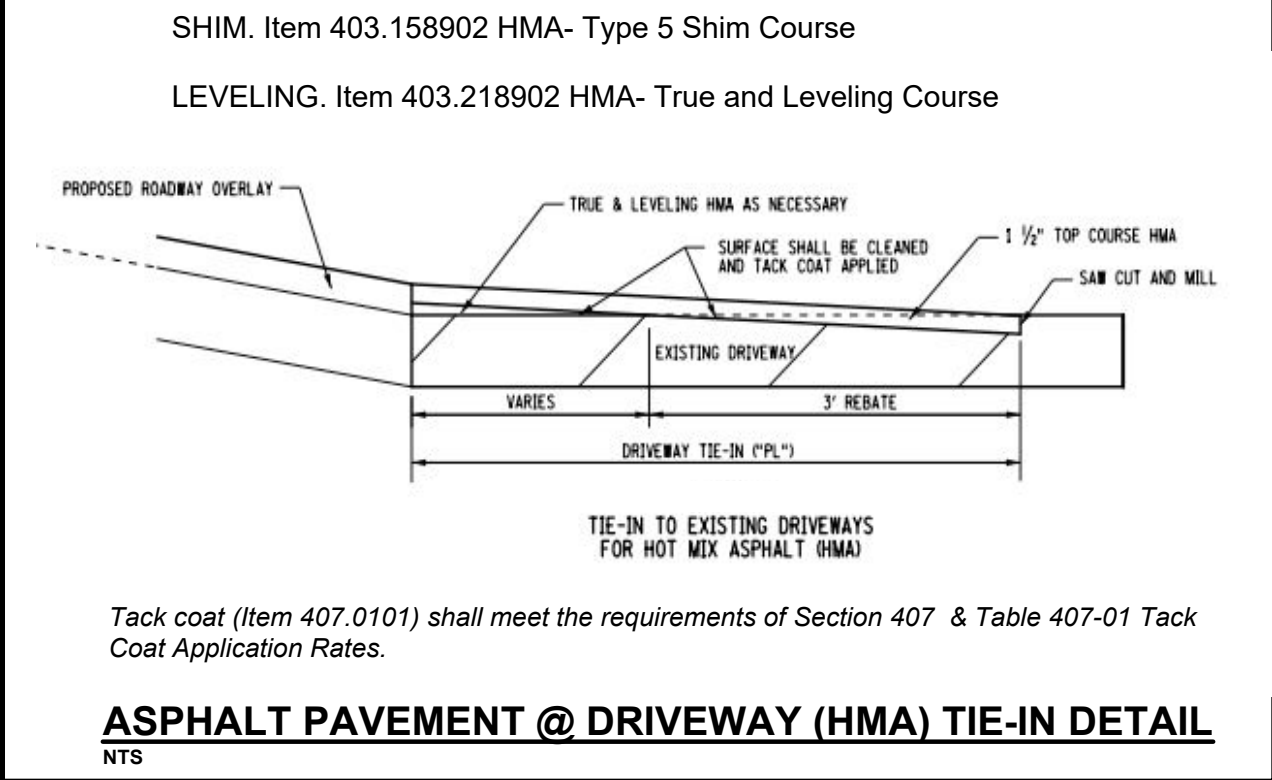

DESIGNER CONTACT STATEMENT: NYSOT - DRIVEWAY WORK IN R.O.W.

"DEL Resource is responsible for the design of this project. Thomas Howard Shelberg is the designer and is familiar with New York State Dept. of Transportation (NYSOT) standards and requirements and shall be contacted at (716) 983-1434 to resolve issues or problems during construction."

"All revisions, including revisions necessary due to field conditions, shall be approved by the NYSOT."

CONTACT: Thomas H. Shelberg, R.A., am ASCE
DEL Resource (716) 983-1434
183 Bathurst Drive - Buffalo, N.Y. 14150
delresource@verizon.net

ENGINEER: Andrew Terragnoli, P.E.
Studio T 3 Engineering (716) 803-6040 ext. 101
2495 Main Street - Suite 301 - Buffalo, N.Y. 14214
andrew@studiot3engineering.com

DEL resource
Design Environment Land

Thomas H. Shelberg, R.A., am ASCE
Architect - Site Consultant
183 Bathurst Drive
Buffalo, New York, 14150
716.983.1434
delresource@verizon.net
www.delresource.com

LJ Construction
lj-construction@outlook.com

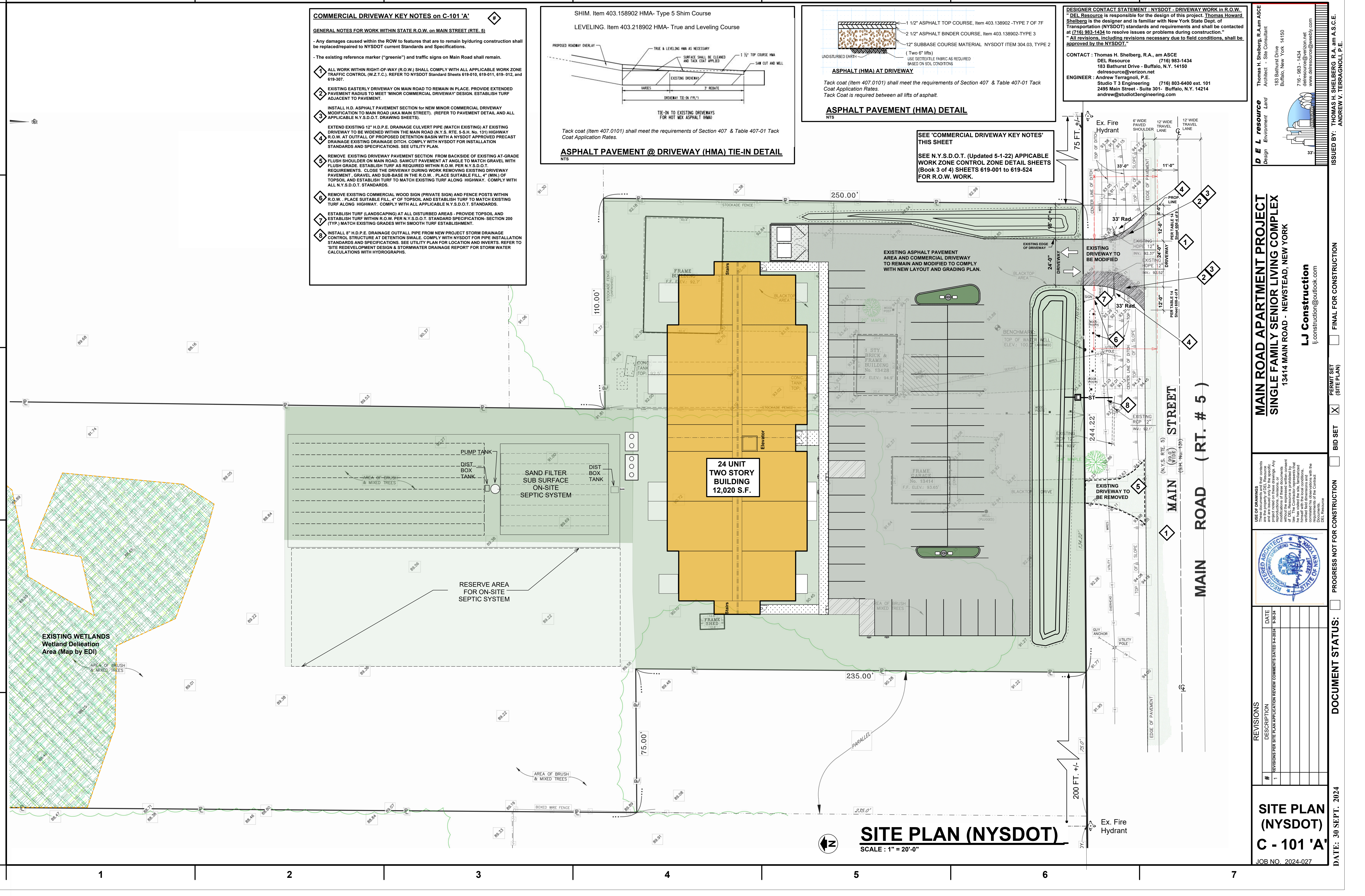

SITE PLAN (NYSOT)
SCALE: 1" = 20'-0"

MAIN ROAD APARTMENT PROJECT
SINGLE FAMILY SENIOR LIVING COMPLEX
13414 MAIN ROAD - NEWSTEAD, NEW YORK



REVISIONS	
#	DESCRIPTION
1	REVISIONS PER SITE PLAN APPLICATION REVIEW COMMENTS DATED 9-4-2024

SITE PLAN (NYSOT)
C - 101 'A'
JOB NO. 2024-027

ISSUED BY: THOMAS H. SHELBERG, R.A., am ASCE.
ANDREW V. TERRAGNOLI, P.E.

DOCUMENT STATUS: PROGRESS NOT FOR CONSTRUCTION BID SET PERMIT SET (SITE PLAN) FINAL FOR CONSTRUCTION

DATE: 30 SEPT. 2024