

General Construction Sequence for Erosion & Sediment Control Measures:
 The sequence of construction activities below is intended to be a general guideline for installation of erosion and sedimentation prevention devices only. Specific construction techniques, details, means, methods, and scheduling are the sole responsibility of the contractor and owner.

1. Obtain all building permits including clearing, stripping, and grubbing permits.
2. Stumps and brush shall be removed from the site.
3. Obtain a dumpster and a debris disposal permit as necessary.
4. Utilize existing paved driveway areas on site where possible as Construction Entrance and Staging.
5. Install Temporary Silt Fencing (Silt Sock as option) at down slope of graded slope and end of swale and end pipes / end section. Maintain & preserve perimeter areas to be left undisturbed.
6. Disturb only enough area required to install the silt fencing.
7. Topsoil for re-use as areas shall be installed as soon as possible. Earthwork & Soil Stockpile areas shall be 50 ft. minimum from any property line and/or R.O.W.
8. Rough grade the entire site. Establish any temporary stormwater diversions or sediment basins as necessary. Seed and stabilize disturbed areas within 14 days of the last construction activity.
9. Install all utilities and structures, including catch basins, culverts, and storm sewers. Temporary trench backfill stockpiles shall be protected from erosion and sedimentation using tarps if left for long periods of time or exposed to rain storms. Minimal disturbance around the trench shall be made to remove as little grass or vegetation from around the vicinity of the trench.
10. Immediately install filter fabric wrap or "Dandy Bag II" catch basin inserts.
11. Install stone subbase and geotextile to all future parking areas and compact to 95% minimum Proctor Density. Use dust control measures as required.
12. Construct all buildings and accessory structures as applicable.
13. Add riprap, flared end sections around pipe outlets or miter cut to match slope. Install erosion control blankets and turf reinforcement mats as per required to slopes steeper than 3:1.
14. Construct the swale bottoms to grade. Install concrete gutter as applicable. Seeded and stabilize swale and detention areas.
15. Install all asphalt and concrete paving.
16. Install remaining landscaping (shrubs, trees, mulch, and stone).
17. When all construction activity is completed and site landscaping is in place such that 70% vegetation coverage. Remove and dispose off-site any remaining temporary erosion control devices.

- KEYED CONSTRUCTION NOTES:**
- 1 Remove existing building structure including floor slab. Stone base to remain in place. Cover with filter fabric, topsoil and seed.
 - 2 Remove asphalt top & binder course as required for new work. Existing stone base to remain where appropriate for reuse for re-developed pavement areas.
 - 3 Remove gravel section as required for new work. Existing gravel stone base to remain where appropriate for reuse for re-developed pavement areas.
 - 4 Existing asphalt parking lot area and commercial driveway to remain in place as required for new work. Refer to Site Plan (C-101) and Grading Plan (C-102) for coordination to grade adjustment with pavement overlay work.
 - 5 Existing asphalt driveway to be used as a temporary Construction Driveway during construction operations. Remove existing asphalt driveway. Stone base to remain in place. Cover with filter fabric, topsoil and seed.
 - 6 Remove existing septic tank and connection piping.
 - 7 Remove existing underground septic field piping network.
 - 8 Remove existing driveway as required (See note # 5 above).
 - 9 Existing perimeter trees and ground cover to remain in place.

NOTE: ALL NEW AREAS OF CONSTRUCTION (BLDG. ADDITIONS, PAVEMENT ADDITIONS AND DETENTION BASIN INCLUDING PERIMETER AREAS FOR MINOR GRADING ADJUSTMENT AMOUNTS TO APPROXIMATELY 0.37 ACRE OF NEW LAND DISTURBANCE.)
 CONTRACTOR SHALL NOT EXCAVATE BELOW 6" BEYOND THIS AREA OF NATURAL GRADES INCLUDING TOPSOIL AND EXISTING GROUND COVER. THE SILT FENCE/SILT SOCK SHALL BE INSTALLED AND USED AS A 'LIMIT OF WORK' FOR THE NEW EARTHWORK GRADING AREA TO THE SILT FENCE / SOCK. MAINTAIN SITE WORK GRADING AREA AND PRESERVE TREE AND BRUSH AREA TO THIS LIMITS OF NEWLY DISTURBED EARTHWORK AREA SOILS. EXISTING BUILDING SLABS TO BE REMOVED HOWEVER ALL STONE SUB-BASE TO REMAIN FOR ADDITIONAL FILL TO BE PLACED & COMPACTED ON TOP FOR RE-DEVELOPMENT WORK.

DEL resource
 Design Environment Land
 Thomas H. Shelberg, R.A. am ASCE
 Architect - Site Consultant
 183 Bathurst Drive
 Buffalo, New York 14203
 716.883.4454
 delresource@verizon.net
 www.delresource.com
LJ Construction
 lj-construction@outlook.com

MAIN ROAD APARTMENT PROJECT
SINGLE FAMILY SENIOR LIVING COMPLEX
 13414 MAIN ROAD - NEWSTEAD, NEW YORK

ISSUED BY: THOMAS H. SHELBURG, R.A. am ASCE.
 ANDREW V. TERRAGNOLI, P.E.



REVISIONS

#	DATE	DESCRIPTION
1	9-20-24	REVISIONS PER SITE PLAN APPLICATION REVIEW COMMENTS DATED 9-4-2024

SITE PREPARATION & EROSION CONTROL PLAN
C - 100
 JOB NO. 2024-027

DOCUMENT STATUS: PERMIT SET (SITE PLAN) BID SET PROGRESS NOT FOR CONSTRUCTION FINAL FOR CONSTRUCTION
 DATE: 30 SEPT. 2024

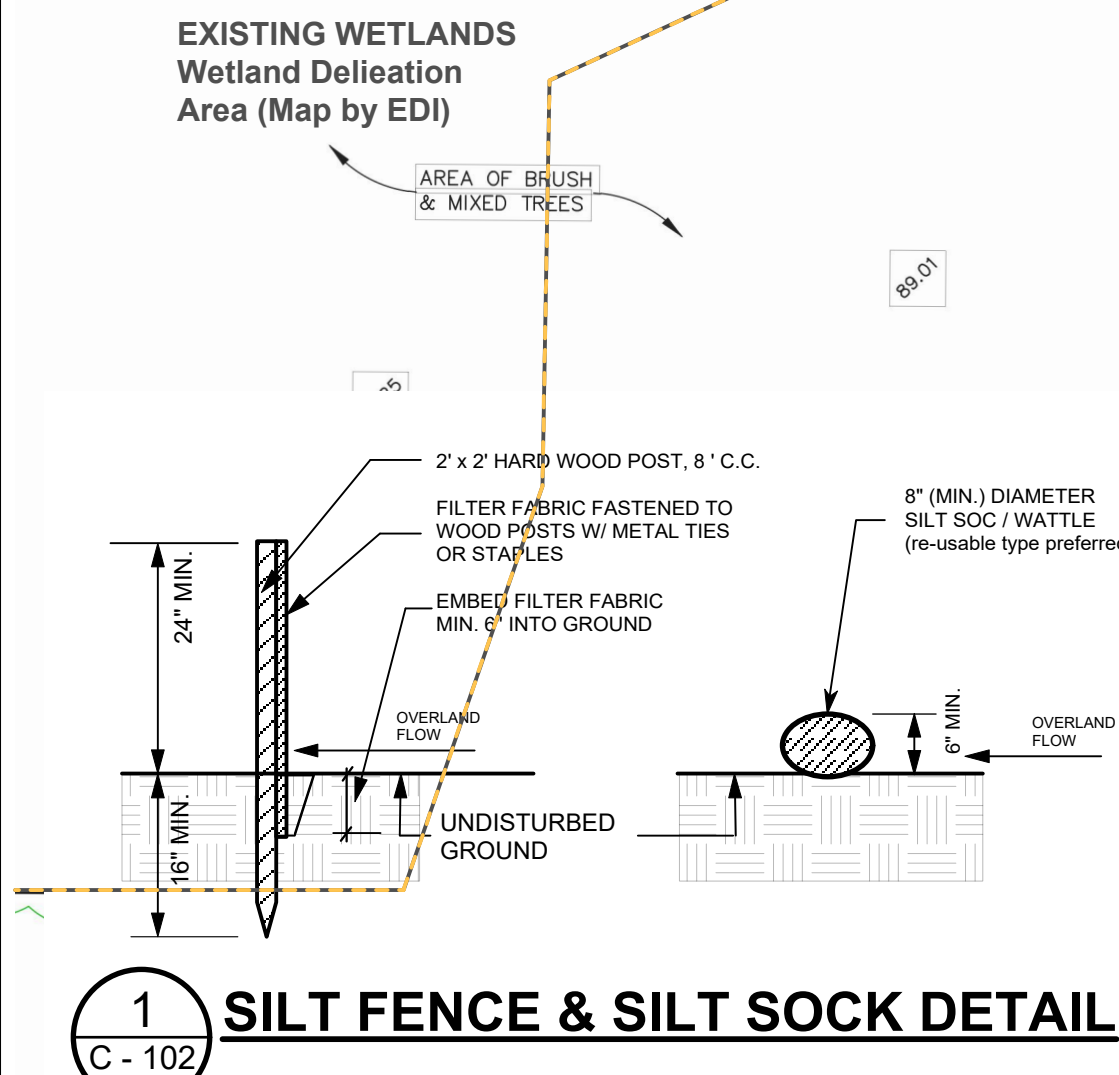
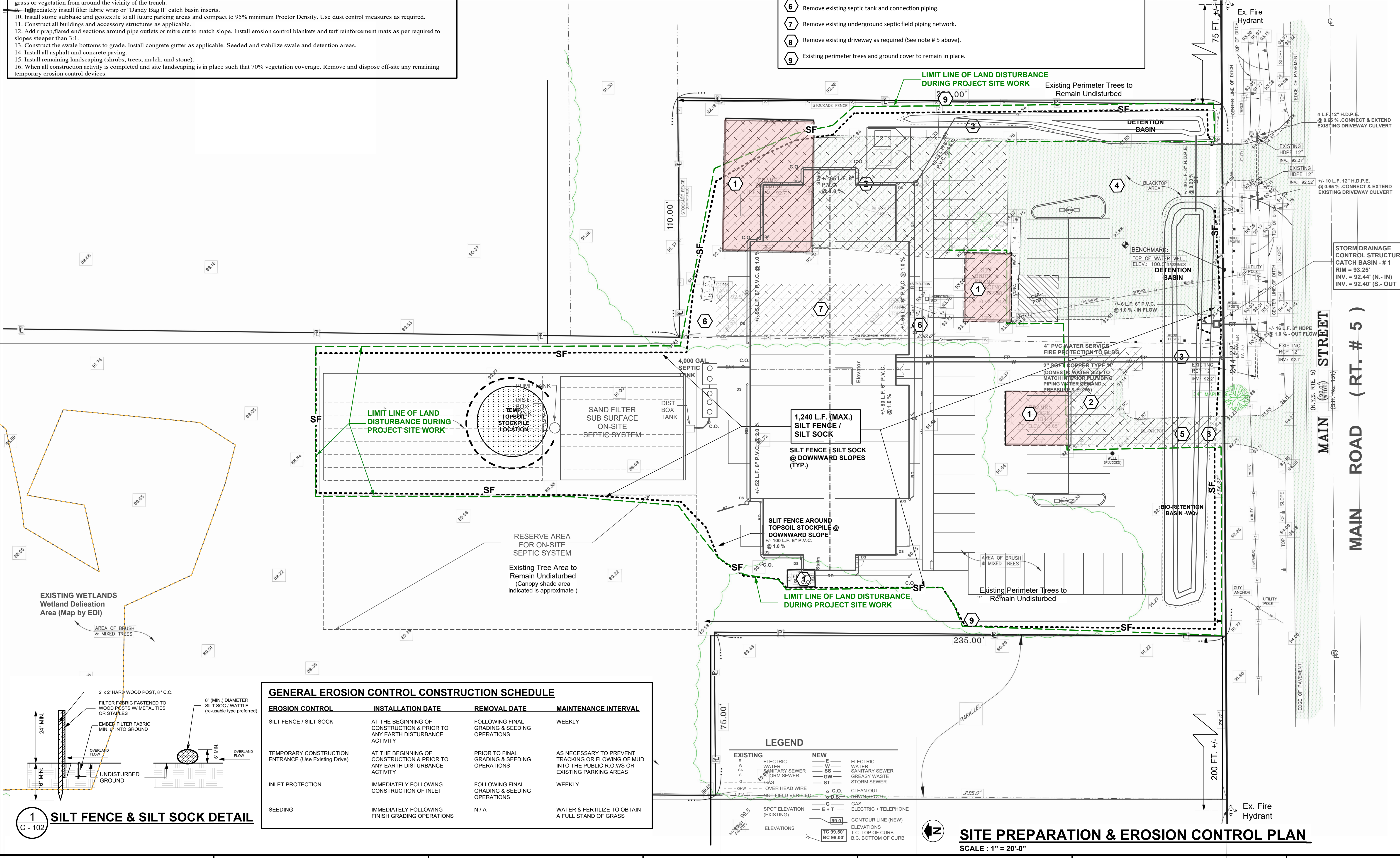

GENERAL EROSION CONTROL CONSTRUCTION SCHEDULE

EROSION CONTROL	INSTALLATION DATE	REMOVAL DATE	MAINTENANCE INTERVAL
SILT FENCE / SILT SOCK	AT THE BEGINNING OF CONSTRUCTION & PRIOR TO ANY EARTH DISTURBANCE ACTIVITY	FOLLOWING FINAL GRADING & SEEDING OPERATIONS	WEEKLY
TEMPORARY CONSTRUCTION ENTRANCE (Use Existing Drive)	AT THE BEGINNING OF CONSTRUCTION & PRIOR TO ANY EARTH DISTURBANCE ACTIVITY	PRIOR TO FINAL GRADING & SEEDING OPERATIONS	AS NECESSARY TO PREVENT TRACKING OR FLOWING OF MUD INTO THE PUBLIC R.O.W.S OR EXISTING PARKING AREAS
INLET PROTECTION	IMMEDIATELY FOLLOWING CONSTRUCTION OF INLET	FOLLOWING FINAL GRADING & SEEDING OPERATIONS	WEEKLY
SEEDING	IMMEDIATELY FOLLOWING FINISH GRADING OPERATIONS	N/A	WATER & FERTILIZE TO OBTAIN A FULL STAND OF GRASS

LEGEND

EXISTING	NEW
-E- ELECTRIC	-E- ELECTRIC
-W- WATER	-W- WATER
-SS- SANITARY SEWER	-SS- SANITARY SEWER
-S- STORM SEWER	-GW- GREASY WASTE
-G- GAS	-ST- STORM SEWER
-OHW- OVER HEAD WIRE	-C.O.- CLEAN OUT
-NOT FIELD VERIFIED	-G.S.- GAS
-SPOT ELEVATION (EXISTING)	-E + T- ELECTRIC + TELEPHONE
-ELEVATIONS	-99.0- CONTOUR LINE (NEW)
-TC 99.50 T.C. TOP OF CURB	-99.0- ELEVATIONS
-BC 99.00 B.C. BOTTOM OF CURB	

SITE PREPARATION & EROSION CONTROL PLAN
 SCALE: 1" = 20'-0"